

MHSAA-MBA STATE BAND EVALUATION

Tupelo High School April 11-13, 2016

I. Welcome to Tupelo High School.

We will do everything in our power to make the Evaluation a positive experience for the Directors and Students. If you need help contact Tupelo Band Director, Jeremy Greenwood or Floyd Stevens.

II. Flow Chart for Band Directors

1. **Bus Drop off of Students & Equipment:** Buses need to go around stadium and temporarily park along the curb south of the Fine Arts Building D. Security will direct Director to Registration
2. **Scores and Charts** should be given to the Registration ladies inside door to hall.
3. **Unload buses and equipment**, except percussion instruments. Put cases back on buses and truck. Students will not be returning to this area and buses will be moved.
4. **Move** into assigned warm-up Rooms at scheduled time – Band Halls
 - a. **Buses** proceed to front parking lot and park in west part by the Natchez Trace. Security will help.
 - b. **Equipment truck** proceed to back of PAC Auditorium and back in to unload percussion equipment. Security will help.
5. **Band warm-up assigned time.** Ladies will let you know when you have 5 minutes left. You must leave the warm-up room at the correct time to make way for the next band and give yourself time to walk across campus to the Performing Arts Center.
6. **Band Escort:** The Band will be escorted single file (from **Student's Right**) across campus to the back of the Performing Arts Center (PAC) and enter through the back stage doors.
7. **Entering Stage:** When the stage is ready single file into places for your concert, adjust your chair and stand and play a chorale if you like. Band will be announced at the scheduled concert time and the performance should start.
8. **After Performance:** After your performance single file (from the **Student's Right**) through door in back of stage on 'stage right' into Sight Reading Room behind stage.
9. **After Sight Reading:** Students should exit through doors on the **Student's Right** and out the doors of the PAC. Proceed to the right to the front of the Auditorium where the buses will be OR to the back side of the parking lot if buses were unable to park outside Auditorium.
10. **Load Buses:** The Director will need to communicate with the bus drivers as to when to move buses to the Auditorium for loading. Even though the drivers can see the band students exit the Auditorium you may want to call. **Exception:** Between 2:00 and 3:30 Tupelo school buses will be picking up students. During this time your students will need to walk to their buses.

- 11. Band Director:** Band Director will see students get to their buses and equipment truck and then should go to the MHSAA office (ticket booth in lobby of the PAC) to see Diane Bruser, MHSAA, to get the band's comment sheets and medals.
- 12. Equipment Trucks:** **Equipment Trucks** should be short trucks or bob trucks. Please, **NO 18** wheelers/semis. There is not enough room to get the trailer to the back of the auditorium.
- 13. Percussion Equipment:** Two sets of percussion equipment will be furnished. It is the responsibility of the performing bands to supply the mallets:
 - a. Stage:** Stage Percussion Equipment should include:
Four Timpani, Bass Drum, Bells, Xylophone, Marimba, Vibraphone, and Chimes (No Mallets).
 - b. Sight Reading:** Percussion Equipment should include:
two Timpani, Bass Drum, Bells, Xylophone.
 - c. Percussionist:** There will be a percussionist on stage to help with set up.
- 14. Directions to PAC Auditorium after Warm Up:** Student helpers will guide each band to the PAC Auditorium by these routes:
 - a. Good Weather:** through the Court Yard to Media Center, go by Media Center on right side, to the side walk by the 'bus pickup' area, to the back of the Auditorium
 - b. Bad Weather:** Stay under the canopies, through the Court Yard to A Building, down inside hall of A Building to I Building, down inside hall of I Building to North door, and to the canopy behind the PAC. **Be respectful of ongoing Classes.**
- 15. Bands staying to hear other bands:** Bands wishing to listen to some of the other concerts may return to the auditorium for the concerts. We encourage you to let your students hear some of the other fine bands in North Mississippi. We ask that you do not enter/exit while a band is performing. We also ask that your students sit together as a group with chaperones. Buses may have to be moved to the back of parking lot depending on the time of day. Security will be available to help.
No Food or Refreshments in the Auditorium.

We hope your student's experiences today at Tupelo High School have been pleasant, educational, and successful. We are honored to have been your Host.

May your travels home today be a safe one. Have a great rest of the school year!!!!!!

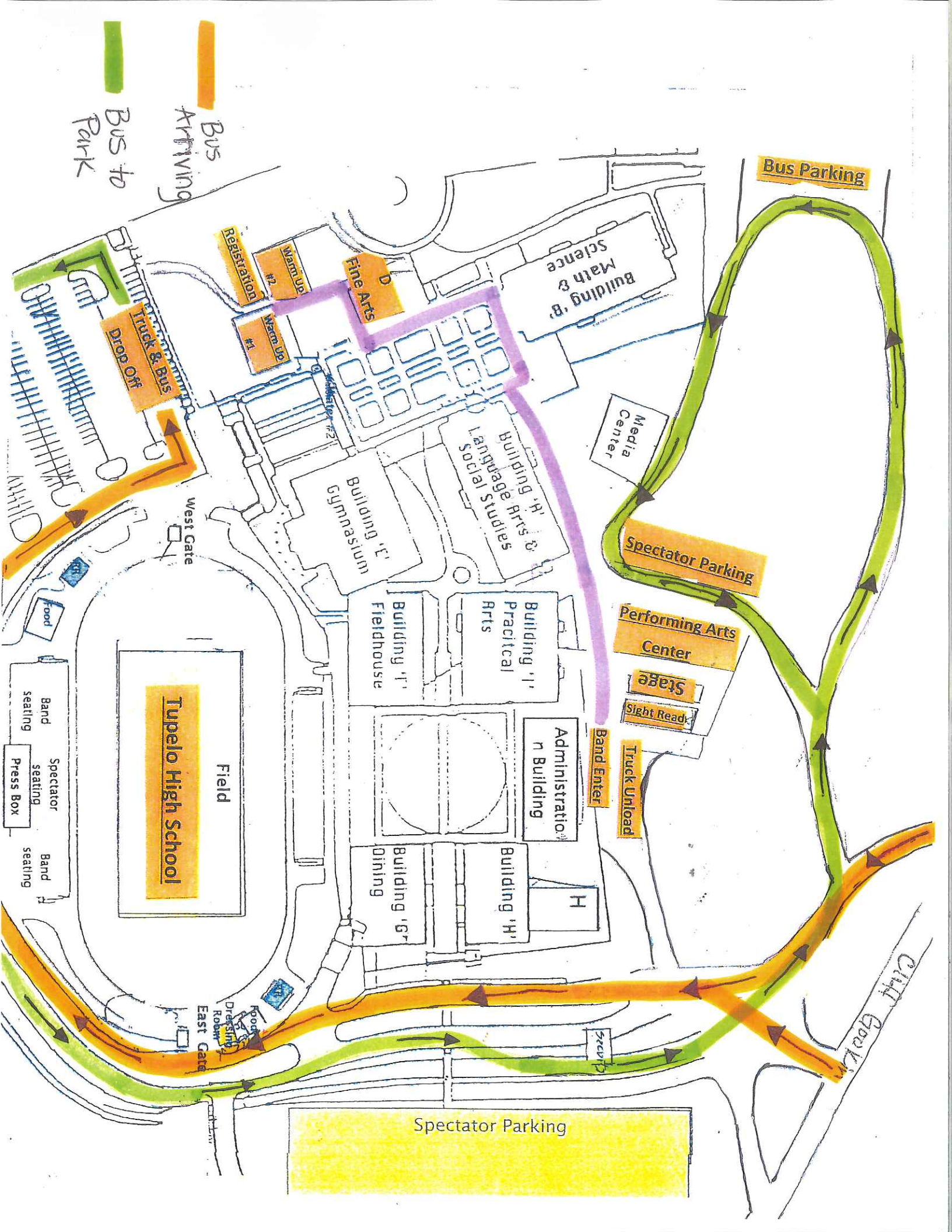

Bus to Park
Arriving

Bus Parking

Drop Off
Truck & Bus

Registration #2
Warm Up #1
Warm Up #2

Fine Arts

Building 'B'
Math & Science

Building 'A'
Language Arts & Social Studies

Building 'E'
Gymnasium

Spectator Parking

Performing Arts Center

Stage

Sight Read

Truck Unload

Band Enter

Administrative Building

Building 'I'
Practical Arts

Building 'F'
Fieldhouse

Tupelo High School
Field

Band seating

Spectator seating

Press Box

Band seating

H

Building 'H'

Building 'G'
Dining

East Gate
Dressing Room
Robbie

Spectator Parking

Cliff Good